

H05VV-F 3G1,50qmm  
schwarz, mit angegossenem Schutzkontakt, Typ 30/UTE,  
Winkelstecker 90°, 16A  
black, with moulded earth contact, type 30/UTE plug,  
90°, 16A  
noir, avec prise moulée avec terre, type 30/UTE, 90°,  
16A

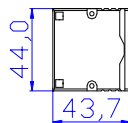
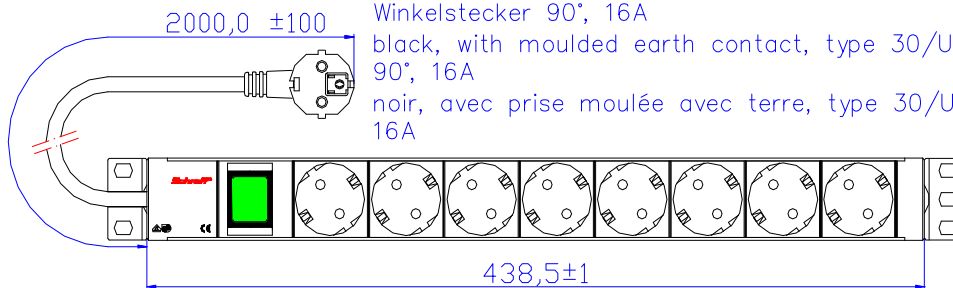

\* Endstücke geschraubt \* Endcaps screwed \* Embouts alambiqué

8 Schutzkontakt - Steckdosen	8 earth contact - sockets	8 avec terre prises
<b>Steckdosen:</b> <ul style="list-style-type: none"><li>nach DIN 49 440, geprüft nach: VDE0620-1;</li><li>2-polig mit Schutzkontakt;</li><li>16A/3600W, AC250V, IP20,</li><li>RAL7035, um 35°gedreht;</li></ul>	<b>Sockets:</b> <ul style="list-style-type: none"><li>DIN 49 440, examined: VDE0620-1;</li><li>2-pole with earthing contact;</li><li>16A/3600W, AC250V, IP20,</li><li>RAL7035, 35°turned;</li></ul>	<b>Prises:</b> <ul style="list-style-type: none"><li>DIN 49 440, selon : VDE0620-1</li><li>2 pôles, 1 prise de terre</li><li>16A/3600W, AC250V, IP20,</li><li>RAL7035, coudé à 35°;</li></ul>
<b>Anschluss:</b> <ul style="list-style-type: none"><li>nicht wiederanschließbar;</li></ul>	<b>Connection:</b> <ul style="list-style-type: none"><li>non rewirable,</li></ul>	<b>Connection:</b> <ul style="list-style-type: none"><li>Reconnection impossible</li></ul>
<b>Profil:</b> 1HE, ALU, eloxiert;	<b>Body:</b> 1HE, ALU, anodized	<b>Profilé :</b> 1U, ALU, anodisé
<b>Kunststoff:</b> <ul style="list-style-type: none"><li>RAL7035, PA6, Glasfaser 30%, Glühdrahtprüfung bis 850°C; V1</li></ul>	<b>Plastic parts:</b> <ul style="list-style-type: none"><li>RAL7035, PA6, fibre glass 30%, Glow wire test up to 850°C ; V1</li></ul>	<b>Éléments plastiques:</b> <ul style="list-style-type: none"><li>RAL7035, PA6, fibre de verre 30%, test au fil incandescent : jusqu'à 850°C ; V1</li></ul>
<b>Haltewinkel:</b> <ul style="list-style-type: none"><li>Anschraubdrehmoment: ca. 2,0Nm</li><li>Montage in 90°- Schritten möglich;</li><li>Für vertikale Montage, Artikelnr. 20110-068 separat bestellen.</li></ul>	<b>Brackets:</b> <ul style="list-style-type: none"><li>Fastening force: aprox. 2,0 Nm</li><li>mounting in 90° steps;</li><li>For vertical fitting, item no. 20110-068, to order separately.</li></ul>	<b>Equerres:</b> <ul style="list-style-type: none"><li>Couple de serrage: env. 2,0 Nm</li><li>Montage au pas de 90°;</li><li>Montage vertical avec : réf. 20110-068, à commander séparément.</li></ul>
<b>Schalter:</b> <ul style="list-style-type: none"><li>2-polig, grün, versenkt</li></ul>	<b>Switch:</b> <ul style="list-style-type: none"><li>2-poles, green, sunked</li></ul>	<b>Interrupteur:</b> <ul style="list-style-type: none"><li>Bipolaire, vert, encastré</li></ul>
<b>Lieferform:</b> <ul style="list-style-type: none"><li>Neutrale Kartonverpackung</li><li>mit Schroff Art.-Nr. und Barcode 39</li></ul>	<b>Form of delivery:</b> <ul style="list-style-type: none"><li>Neutral carton box</li><li>With Schroff Item no. and bar code 39</li></ul>	<b>Conditionnement :</b> <ul style="list-style-type: none"><li>Emballage dans carton neutre</li><li>Avec réf. Schroff et code barre 39</li></ul>
<b>Lieferumfang:</b> <ul style="list-style-type: none"><li>1 x Steckdosenleiste</li><li>2 x 19" Befestigungswinkel ( Lose beigelegt )</li></ul>	<b>Extent of delivery:</b> <ul style="list-style-type: none"><li>1 x Socket strip</li><li>2 x 19" mounting brackets (Loose)</li></ul>	<b>Composition :</b> <ul style="list-style-type: none"><li>1 x Bâti de prises</li><li>2 x Equerre 19" ( en vrac )</li></ul>
<b>Thermische Eigenschaften</b> <ul style="list-style-type: none"><li>Betriebs- Umgebungstemperatur 0 ... +55°C</li><li>Lagertemperatur -20... +75°C</li><li>Betriebs-Umgebungsfeuchte 5... 95% nicht kondensierend</li></ul>	<b>Thermal specifications</b> <ul style="list-style-type: none"><li>Operating temperature range 0...+55°C</li><li>Storage temperature range -20... +75°C</li><li>Operating humidity range 5...95% relative humidity, non-condensing</li></ul>	<b>Spécification thermiques</b> <ul style="list-style-type: none"><li>Temperature de fonctionnement 0°:+55°</li><li>Temperature de stockage -20°... +75°</li><li>Humidité en fonctionnement 5%... 95% sans condensation</li></ul>